

- NOTES:
 1. DO NOT SCALE THIS DRAWING.
 2. BREAK ALL SHARP EDGES.
 3. ALL DIMENSIONS DISPLAYED IN PARENTHESES ARE FOR REFERENCE ONLY.
 4) WHEN USING A DASH NUMBER WITH A DASH # SUFFIX, MAKE SURE THE DASH NUMBER SUFFIX IS THE SAME FOR THE MAJOR COMPONENTS IN THE ASSY. DO NOT ASSUME THE ACTUAL DASH NUMBERS ARE THE SAME.
 EXAMPLE: A 940215-1EP USES THE FOLLOWING MAJOR COMPONENTS:
 802115-1EP
 802160-41EP
 802220-41EP

REVISIONS		DATE	BY
REV.	DESCRIPTION		
A	INITIAL RELEASE	04/20/06	EK

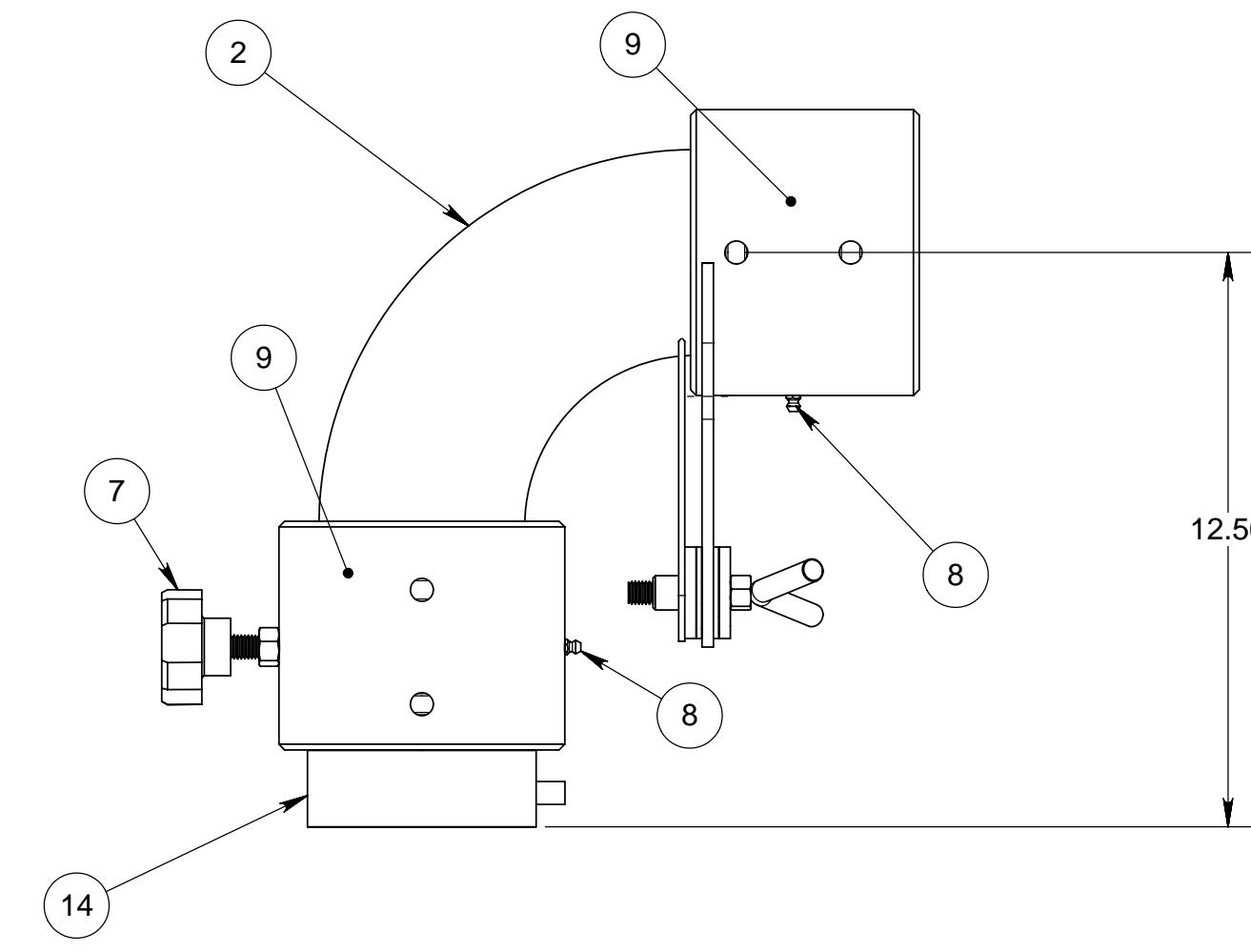
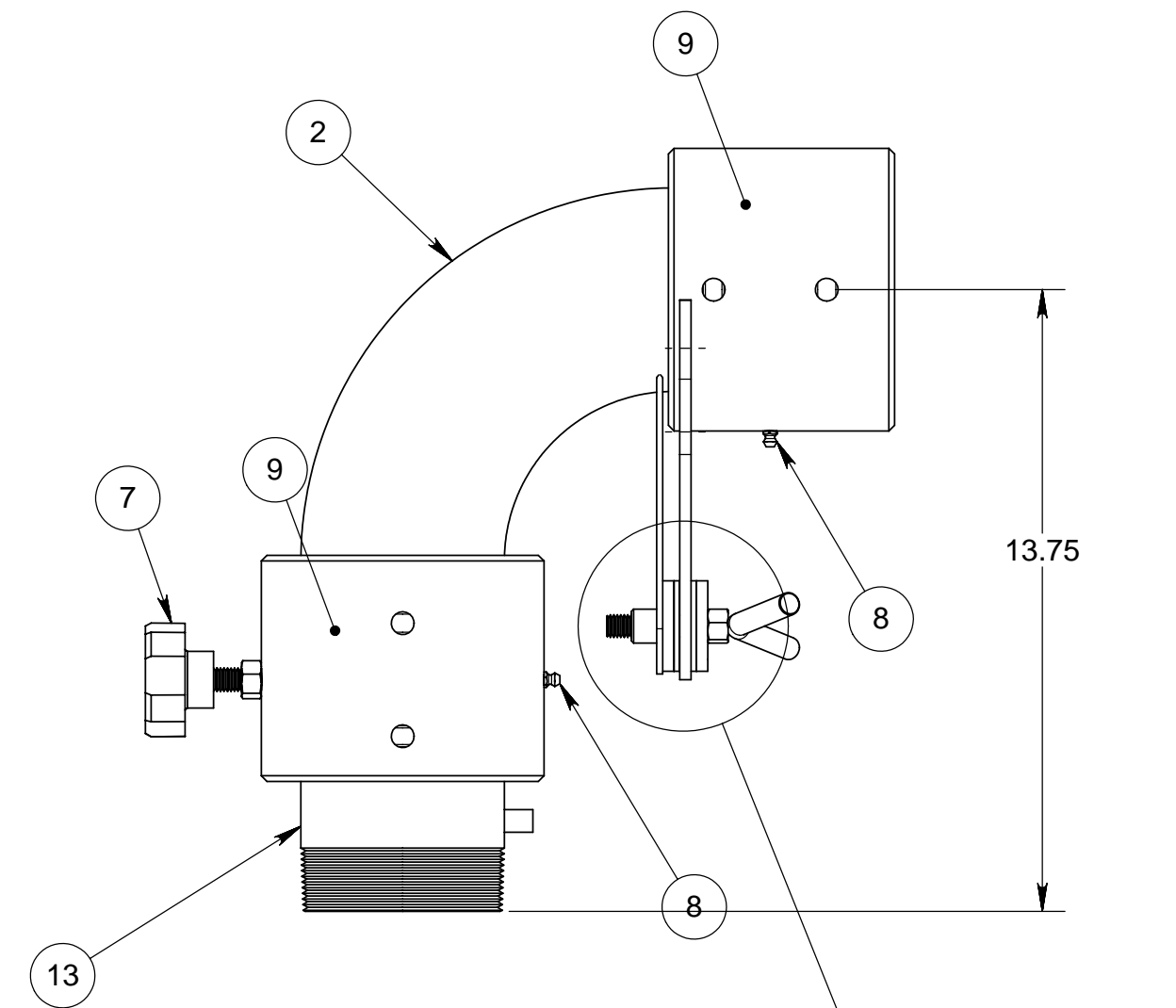
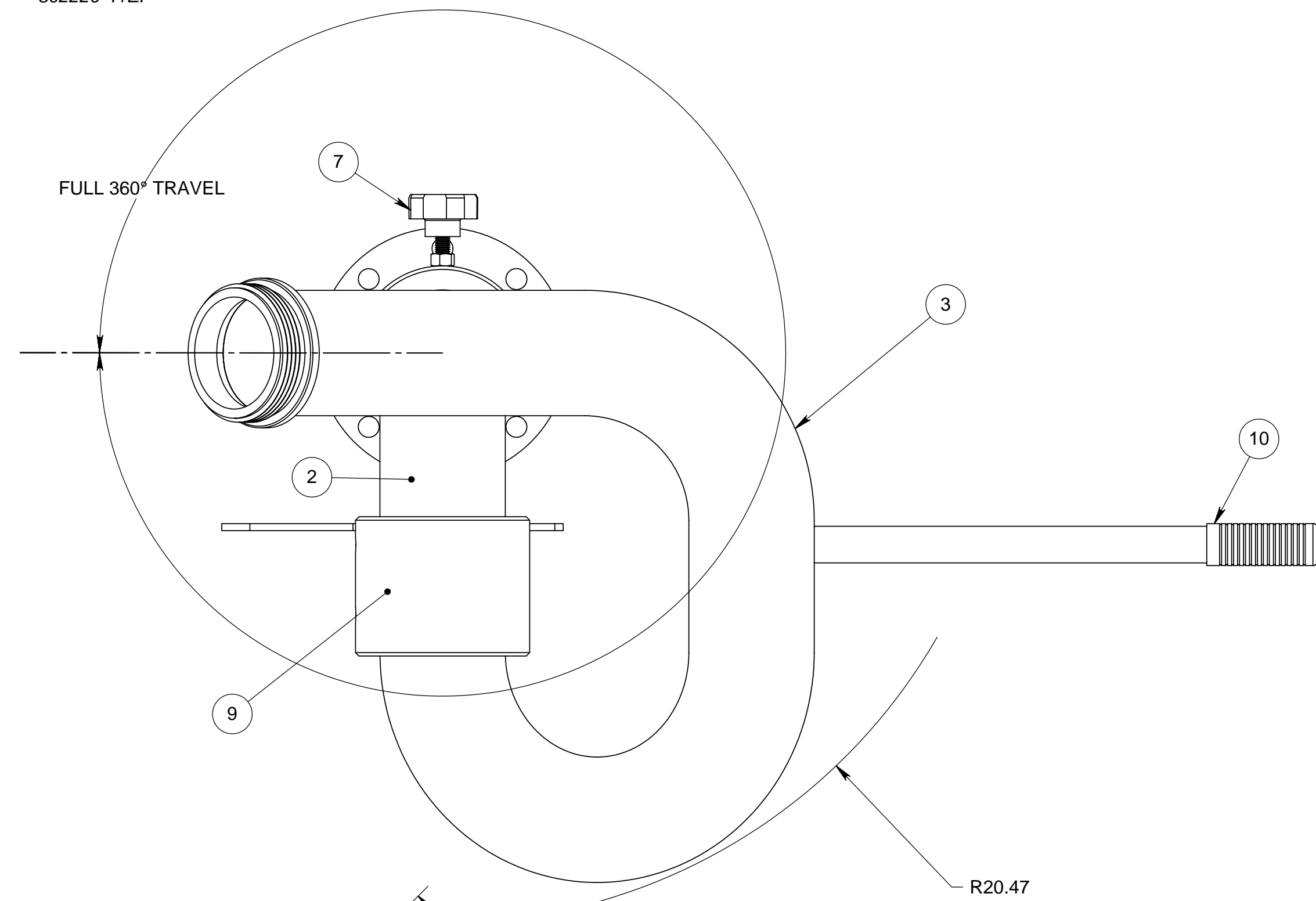

940215-21

940215-31

DETAIL A
 SAME FOR ALL
 DASH NUMBERS

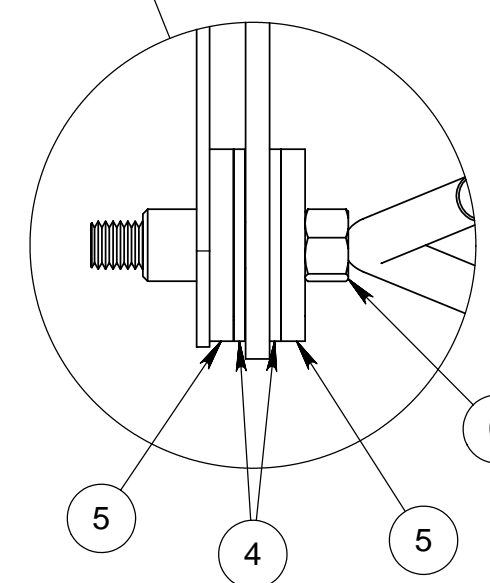

PERFORMANCE SPECIFICATIONS
WATER:
 FLOW RATE: 1500-3000 USGPM
 OPER. PRESSURE RANGE: 50-150 PSIG
 PRESSURE LOSS @ 2000 USGPM: 17 PSIG
 OPTIMUM OPER. PRESSURE: 120PSIG (INLET)
MATERIALS:
 WATERWAY: 304 STAINLESS STEEL
 SWIVELS: ALUMINUM BRONZE
 THREAD BUTT: ALUMINUM BRONZE
 UNIT WEIGHT: 95 LBS ± DEPENDING ON BASE (DRY)

SUFFIX TABLE	
DASH #	DESCRIPTION
NO SUFFIX	POWDER COAT STANG RED
EP	EPOXY COAT STANG RED
P	POLISHED (SS ONLY)
NP	NOT PAINTED

SEE NOTE 4

CONFIGURATION TABLE	
940210-1	MONITOR, 4.00" STATION W/4.0-150#RF & BLADELOCK, SS
940210-11	MONITOR, 4.00" STATION W/6.0-150#RF & BLADELOCK, SS
940210-21	MONITOR, 4.00" STATION W/4.0NPT(M) & BLADELOCK, SS
940210-31	MONITOR, 4.00" STATION W/4.0NPT(F) & BLADELOCK, SS
940210-41	MONITOR, 4.00" STATION W/4.0-150#FF & BLADELOCK, SS
940210-51	MONITOR, 4.00" STATION W/6.0-150#FF & BLADELOCK, SS

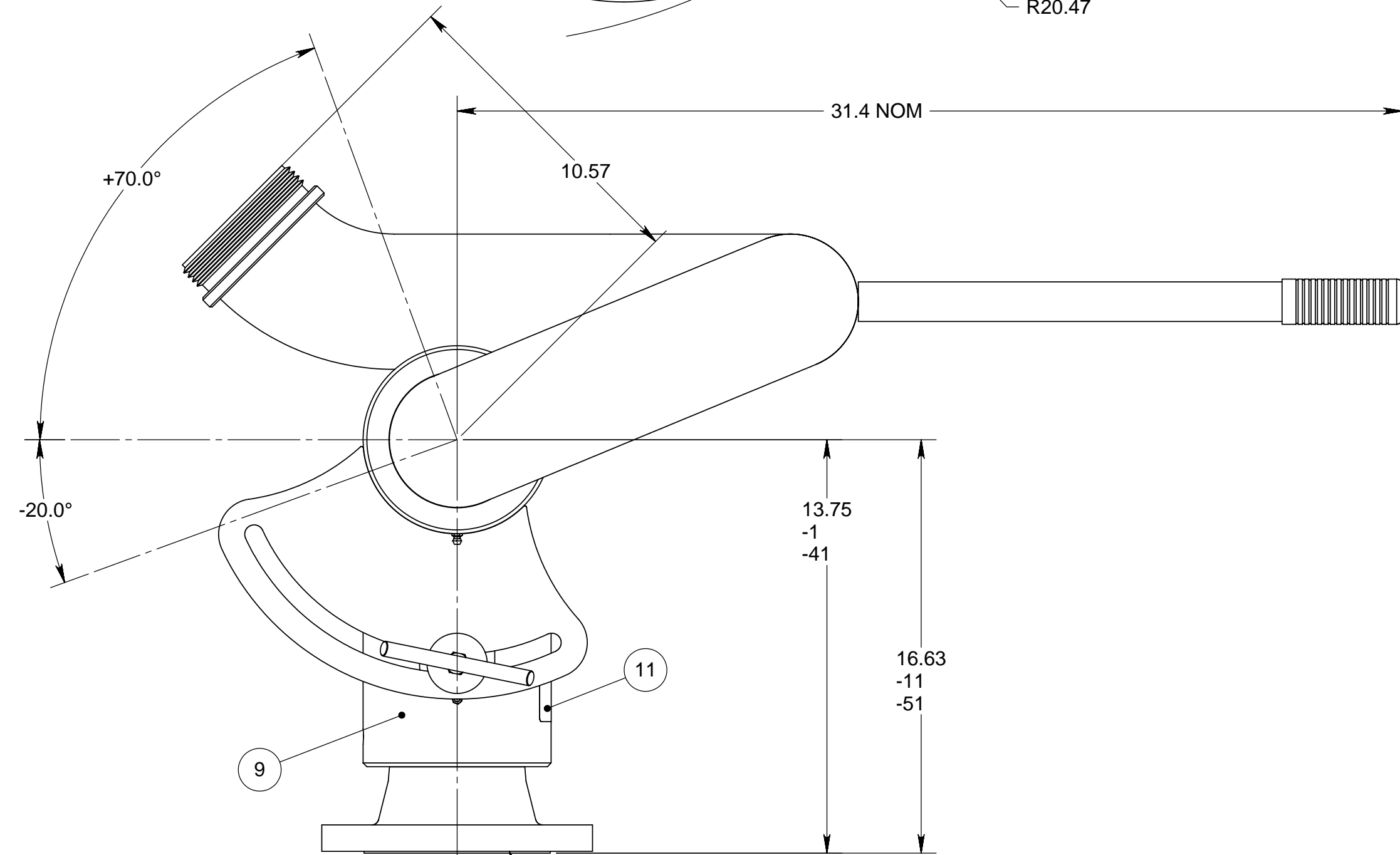

940215-1, -11, -41, -51

1 12 15 16

1	-	-	-	-	-	16	802115-51	BASE INTAKE, 4.00" W/6.0-150#FF, SS-AB
-	1	-	-	-	-	15	802115-41	BASE INTAKE, 4.00" W/4.0-150#FF, SS-AB
-	-	1	-	-	-	14	802105-31	BASE INTAKE, 4.00" W/4.0NPT(F), SS-AB
-	-	-	1	-	-	13	802105-21	BASE INTAKE, 4.00" W/4.0NPT(M), SS-AB
-	-	-	-	1	-	12	802115-11	BASE INTAKE, 4.00" W/6.0-150#RF, SS-AB
1	1	1	1	1	1	11	100853-1	PLATE, ALUM ID
1	1	1	1	1	1	10	100256-8	GRIP,HAND,BLK PLSTC,#RG28055
2	2	2	2	2	2	9	103831-1	SWIVEL KIT, 4.0 NOM.
2	2	2	2	2	2	8	100112-8	FITTING, ZERK, STR, 1/4-28UNF, CRES
1	1	1	1	1	1	7	102537-1	LOCK KNOB, 50-20UNF-2A THD
1	1	1	1	1	1	6	103815-11	LOCK HANDLE WELDMENT
2	2	2	2	2	2	5	103817-11	WASHER, FLAT, 2.00OD X .56ID X .25T, 304
2	2	2	2	2	2	4	105448-11	WASHER, FLAT, .50ID X 2.00OD X.120T, DELRIN
1	1	1	1	1	1	3	802220-41	ELL, UPPER, 4.00" STATION W/BLADELOCK, SS
1	1	1	1	1	1	2	802160-41	ELL, LOWER, 4.00" LR W/BLADELOCK, SS
-	-	-	-	-	1	1	802115-1	BASE INTAKE, 4.00" W/4.0-150#RF, SS-AB
-51/QTY.	-41/QTY.	-31/QTY.	-21/QTY.	-11/QTY.	-1/QTY.	ITEM NO.	PART NUMBER	DESCRIPTION

UNLESS OTHERWISE SPECIFIED: DIMENSIONS ARE IN INCHES
 TOLERANCES
 DECIMALS ANGULAR
 .XX ±.03 ±2°
 .XXX ±.010

DO NOT SCALE DRAWING

TREATMENT SEE NOTES

FINISH SEE NOTES

SIZE SUPP.#

D DATE

SCALE



STANG INDUSTRIAL PRODUCTS

1250 RAILROAD ST.
 CORONA, CA 92882

**MONITOR, 4.00" STATION
 W/BLADELOCK**

P/N	940215	MATL	SS-AB
CAGE#	55822	DRAWN	EK
DATE	04/19/06	DESIGN	
SCALE	NTS	SHEET	1 OF 1
REVISION	A		

The information and design disclosed herein is the property of Stang Industries Inc. All proprietary use and sales rights thereto are reserved. This disclosure is confidential and must not be copied in whole or part.